

LOOT NFT WORLD



HABN Island

Vault Atoll



Isle of Fund

*Royaume de
Satoshi*

*Kingdom of
X by SL*

*The Great
Empire*

*Territorio
LTT ST*



*Approved by Registrar of
Lands of
Jimmy
Jimmy Auckland*



THE ARISTOCRATS

The richest state in Loot NFT World. Special tablets are used to conduct high value auctions at galas and special events. The aristocrats donate 7% of their earnings to the Stakers, a special group of people, from the Great Empire. Ever since the marriage of the Sultan's daughter and the prince of X by SL, the Kingdom also donates 3% of its earnings to the Royaume De Satoshi.

GEOGRAPHY

| | |
|---------------|-----------------------------|
| COASTLINE | 93.89 KM (58.34 MILES) |
| BORDERS | OCEAN, THE GREAT EMPIRE, SL |
| HIGHEST POINT | PEAK HERMES +7899 M |
| LOWEST POINT | PORT OF EXCLUSIVITY 0 M |
| PLOTS | 549 |
| SCALE | 1:50000 |

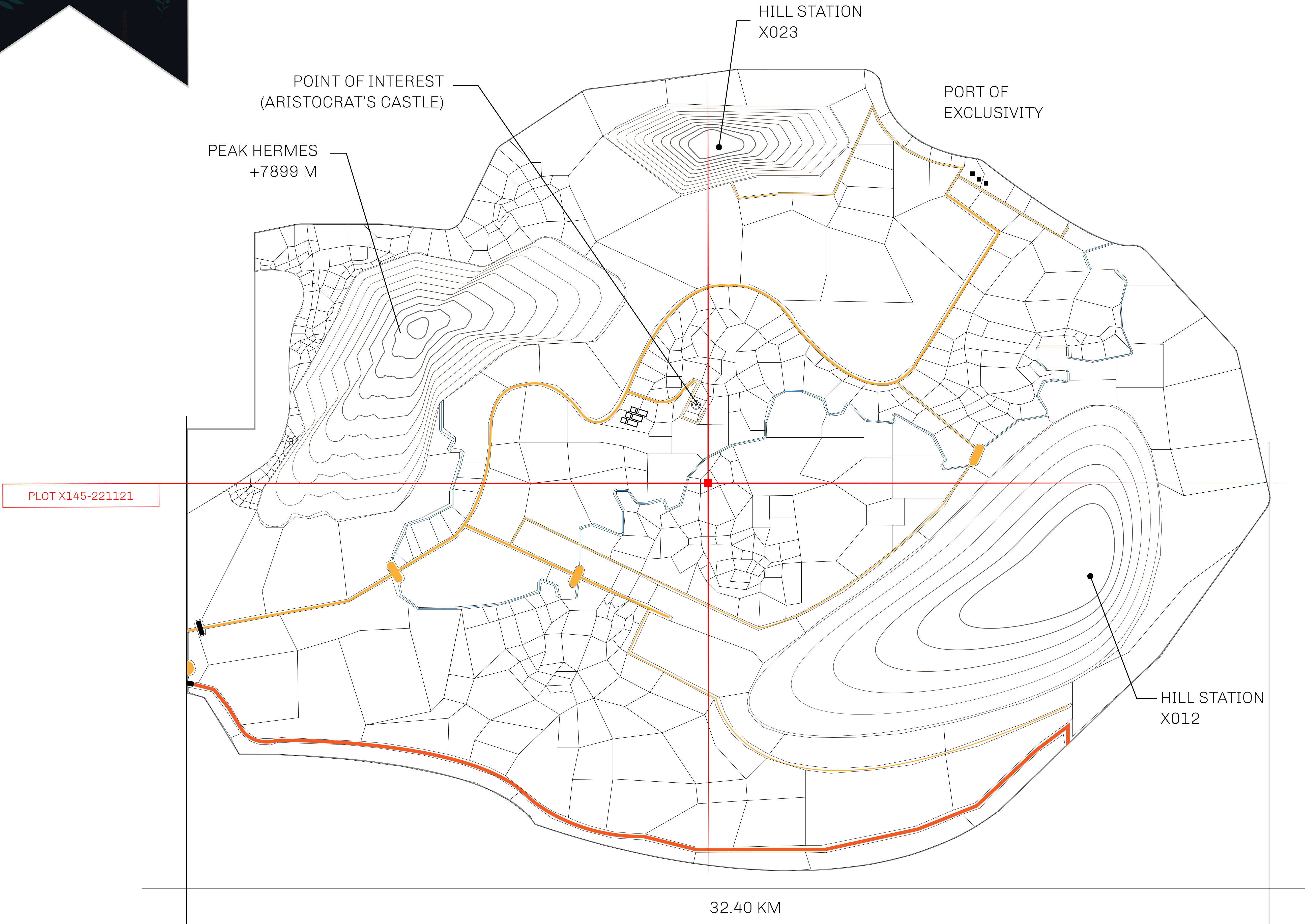
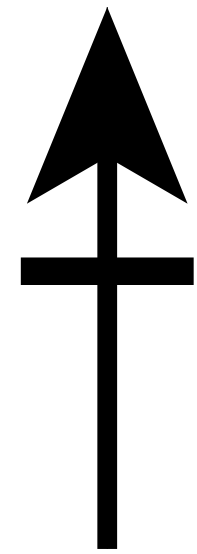



| | | | |
|---------------------------------------|---|------------------------------------|---------------|
| <i>H.M. LNFT Land Registry</i> | | TITLE NUMBER | |
| | | X145-221121 | |
| ADMINISTRATIVE AREA | KINGDOM OF X BY SL | ISSUED 22 November 2021 <i>bi.</i> | SCALE 1/50000 |
| OWNER ENTITLEMENT | Type W-XBYSL: Share of 0.5% of all X by SL winning bid values based on number of NFT Stories minted (rewarded in Credits); Automatic invite to X by SL; Mint 4 NFT Stories | | |

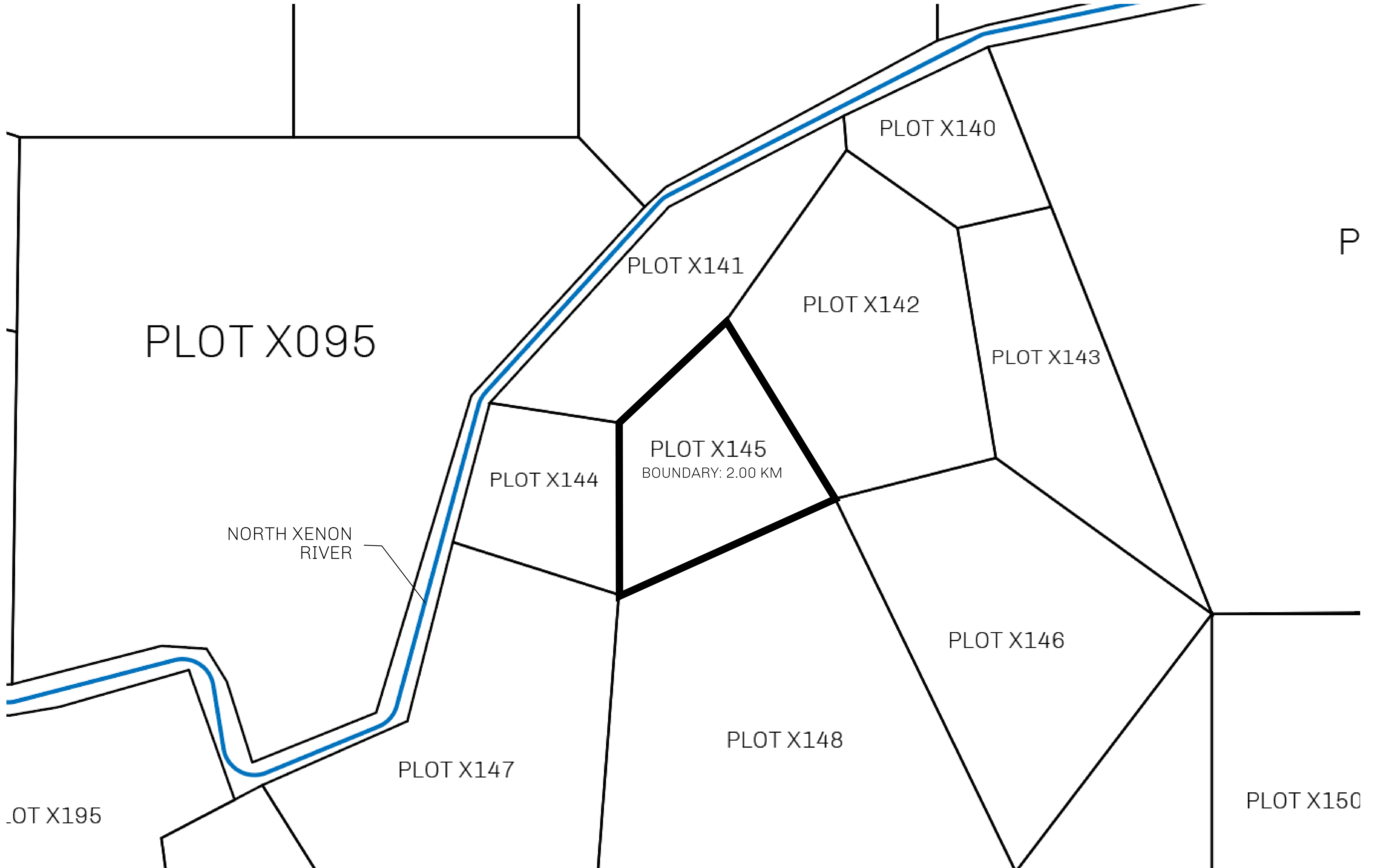

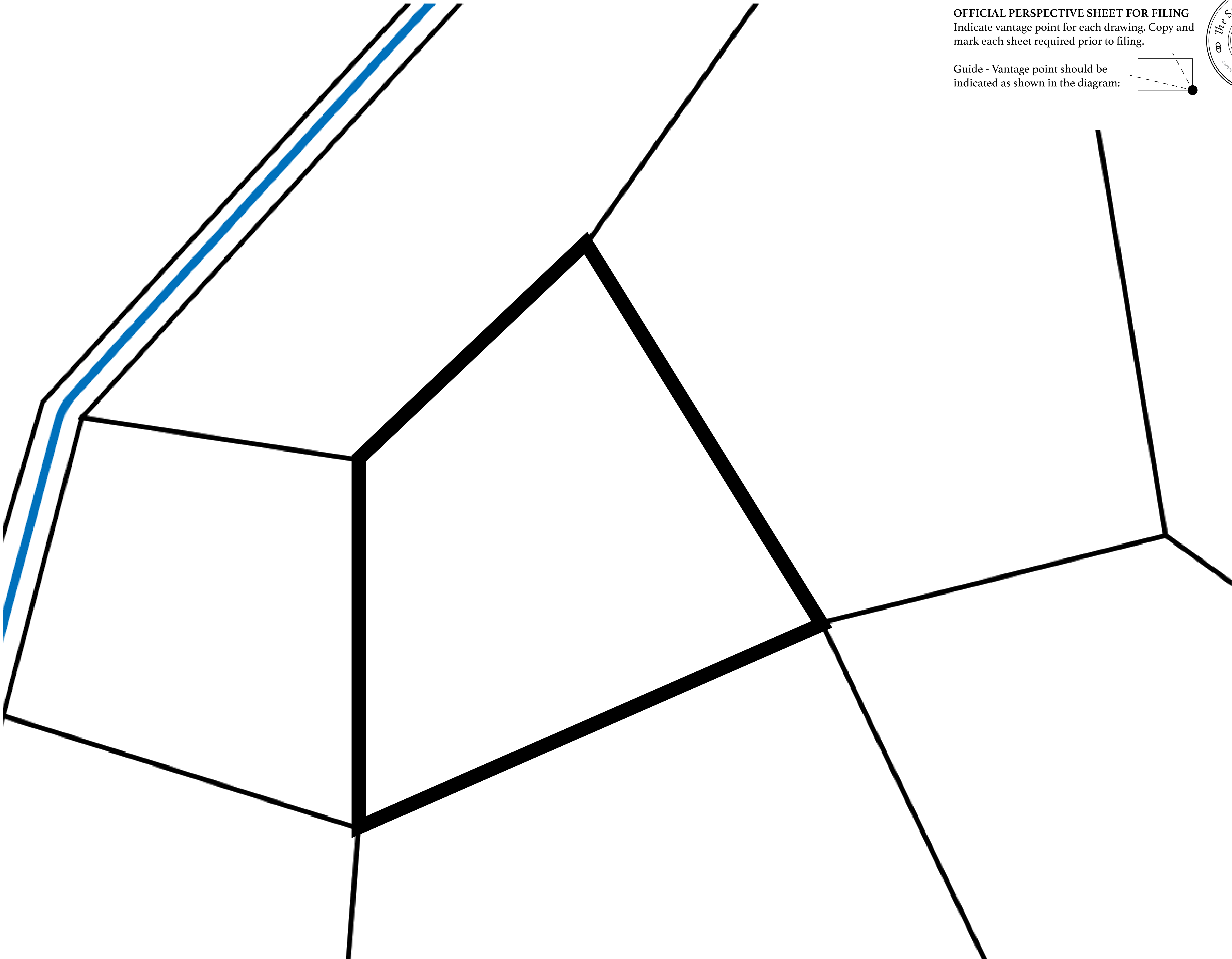

OFFICIAL PERSPECTIVE SHEET FOR FILING
Indicate vantage point for each drawing. Copy and mark each sheet required prior to filing.

Guide - Vantage point should be indicated as shown in the diagram:

