

LOOT NFT WORLD

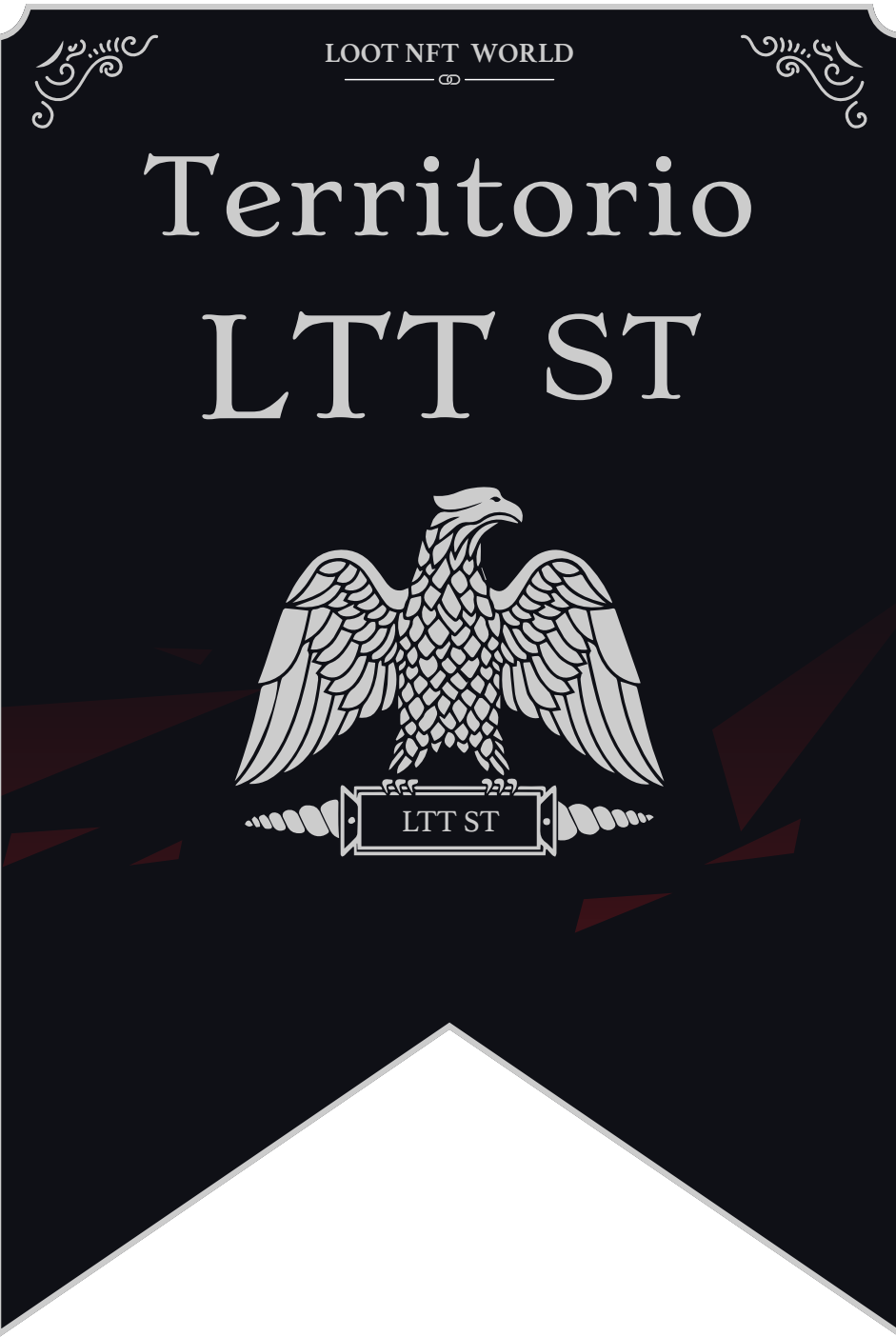



THE SPANISH ARMADA

The most flamboyant of all of the states, this Spanish-speaking territory houses a clash of cultures. From the LTT trades in the El Mercado district to the solicitations for invites to the Great Empire, and even the traveling Caravans, it is a transient place; people are always on the move on the way to the Great Empire or a trek through the Dividing Range to the Royaume De Satoshi. Commerce uses derivations of LTT such as LTTE, LTTB, and LTTG.

GEOGRAPHY

COASTLINE	193.03 KM (119.94 MILES)
BORDERS	OCEAN, THE GREAT EMPIRE
HIGHEST POINT	MT ELEUTHERIA +1392 M
LOWEST POINT	PUERTO DE LTT 0 M
PLOTS	1045
SCALE	1:50000

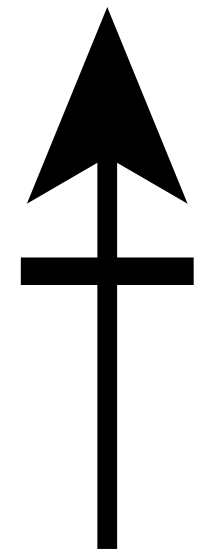



H.M. LNFT Land Registry		TITLE NUMBER	
		T0703-221121	
ADMINISTRATIVE AREA	TERRITORIO LTT ST	ISSUED 22 November 2021 <i>B.I.</i>	SCALE 1/50000
OWNER ENTITLEMENT	Type W-T: Share of 0.1% of all BUN sales (rewarded in Credits) plus 1% of all LTT redeemed based on number of NFT Stories minted; Mint 4 NFT Stories		

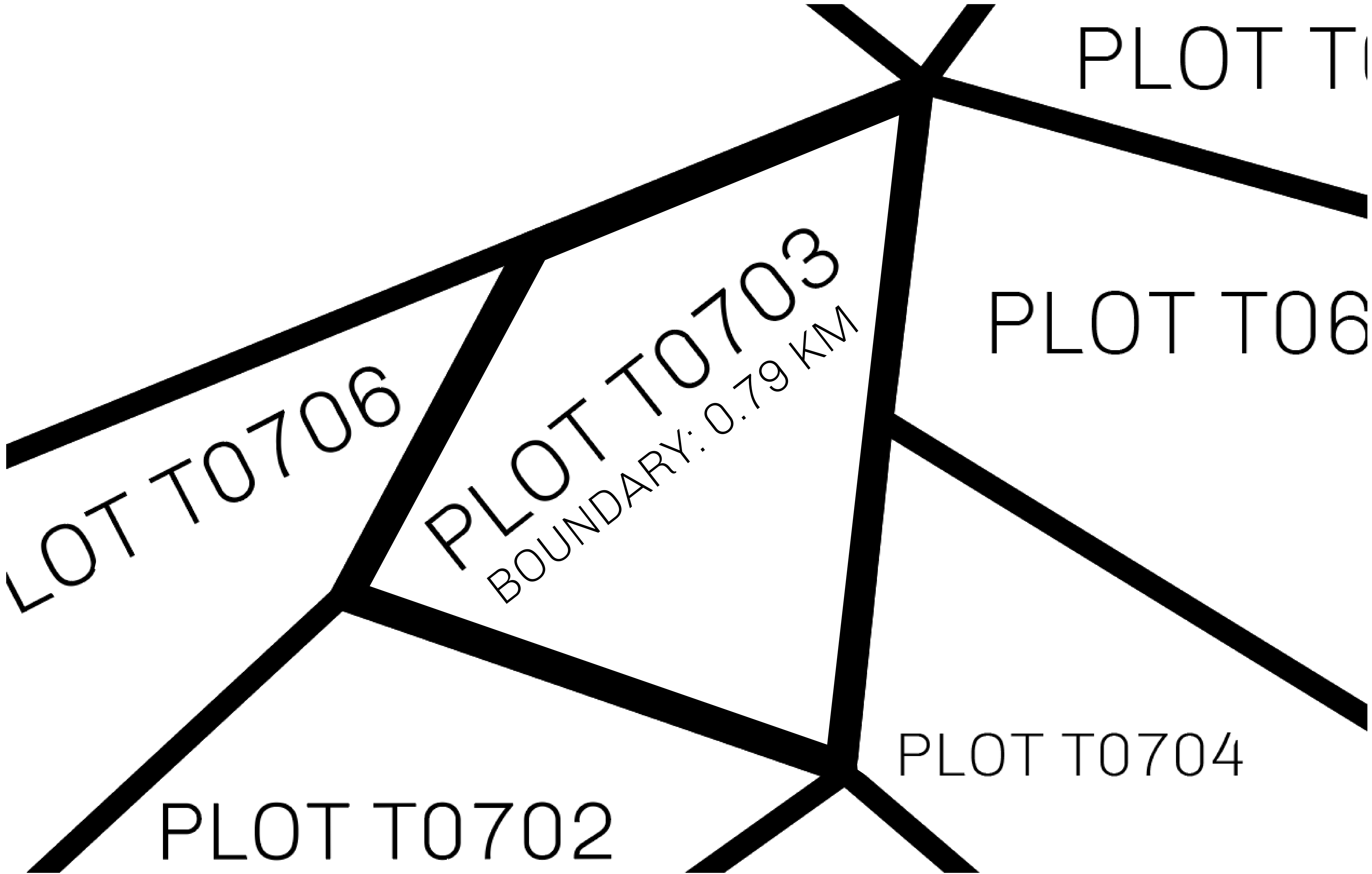

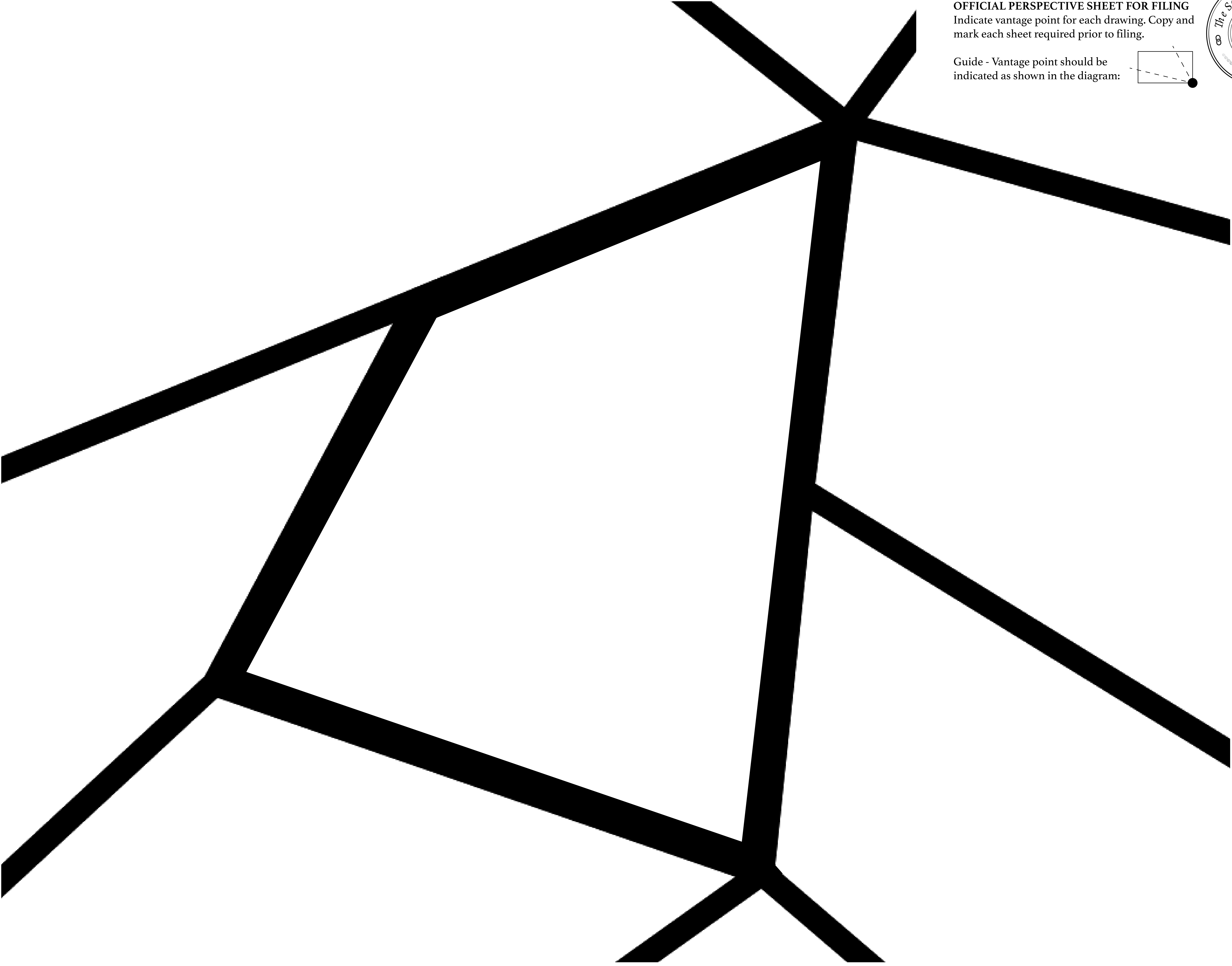

OFFICIAL PERSPECTIVE SHEET FOR FILING
Indicate vantage point for each drawing. Copy and mark each sheet required prior to filing.

Guide - Vantage point should be indicated as shown in the diagram:

