

LOOT NFT WORLD



HABN Island

Vault Atoll

*Royaume de
Satoshi*

*Kingdom of
X by SL*

*The Great
Empire*



Isle of Fund



*Approved by Registrar of
Lands*

John Dwyer - Administrator TGE

*Territorio
LTT ST*



HER MAJESTY'S GATED WORLD

As an economic and ruling powerhouse, the Great Empire controls the issuance and trade of BUN, LTT, and USDC reward credits. Decisions by its sitting parliamentarians affect Loot NFT World. Following the last war, border controls are tight and only invitees can enter. Each Sunday, all eyes focus on the Arena and the Crown's Podium, where battle-bidding auctions rage. The battle pit is not for the fainthearted and strategy plays a crucial role in winning.

GEOGRAPHY

COASTLINE	462.64 KM (287.47 MILES)
BORDERS	OCEAN, ROYAUME DE SATOSHI, X BY SL & TERRITORIO LTT ST
HIGHEST POINT	MOUNT ARES +8120 M
LOWEST POINT	NFT PORT 0 M
PLOTS	2284
SCALE	1:50000

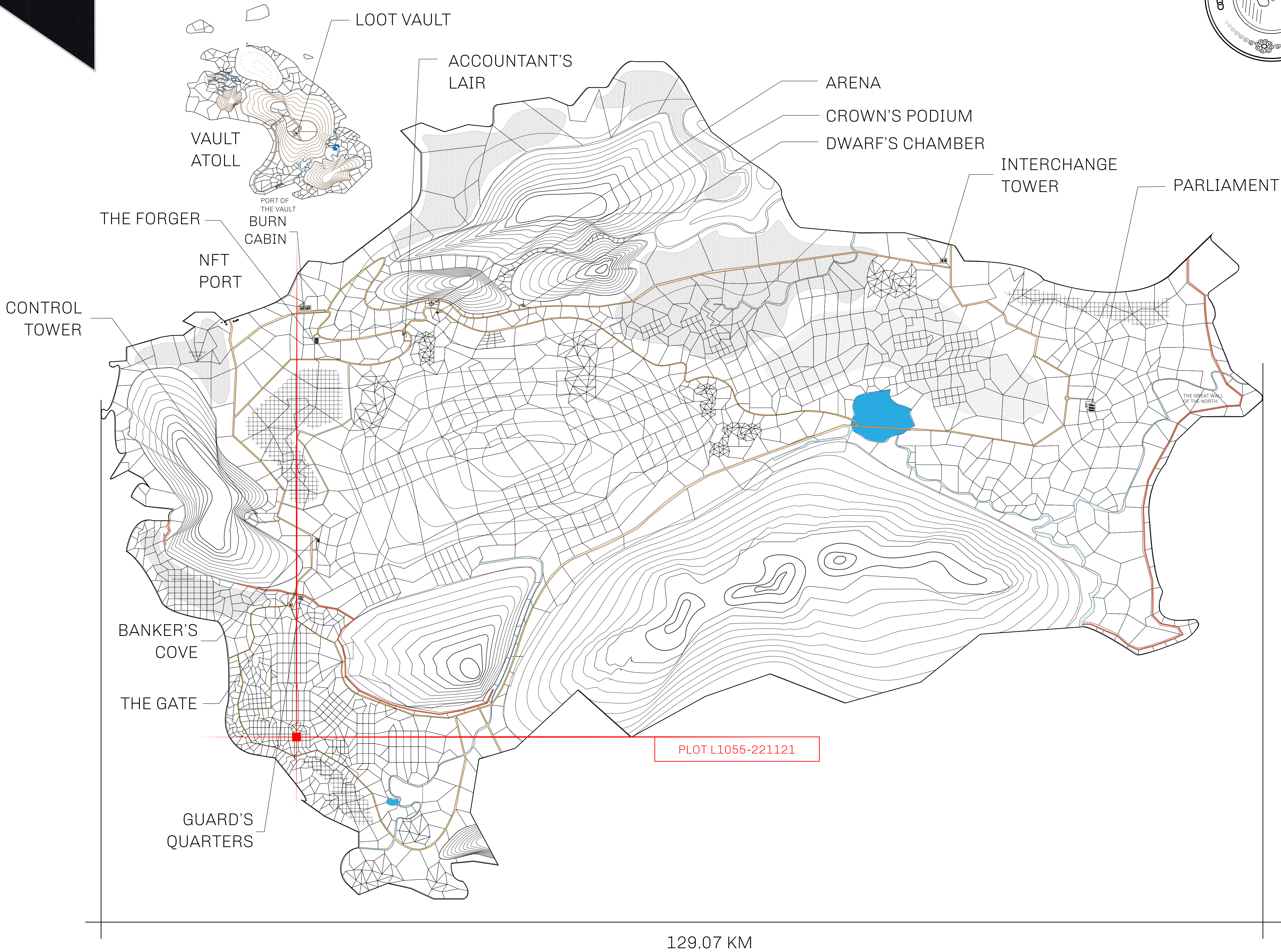



<i>H.M. LNFT Land Registry</i>		TITLE NUMBER	
		L1055-221121	
ADMINISTRATIVE AREA	THE GREAT EMPIRE	ISSUED 22 November 2021 <i>bi.</i>	SCALE 1/50000
OWNER ENTITLEMENT	Type W-GE: Share of 0.3% of all BUN sales based on number of NFT Stories minted (rewarded in Credits); Mint 4 NFT Stories		

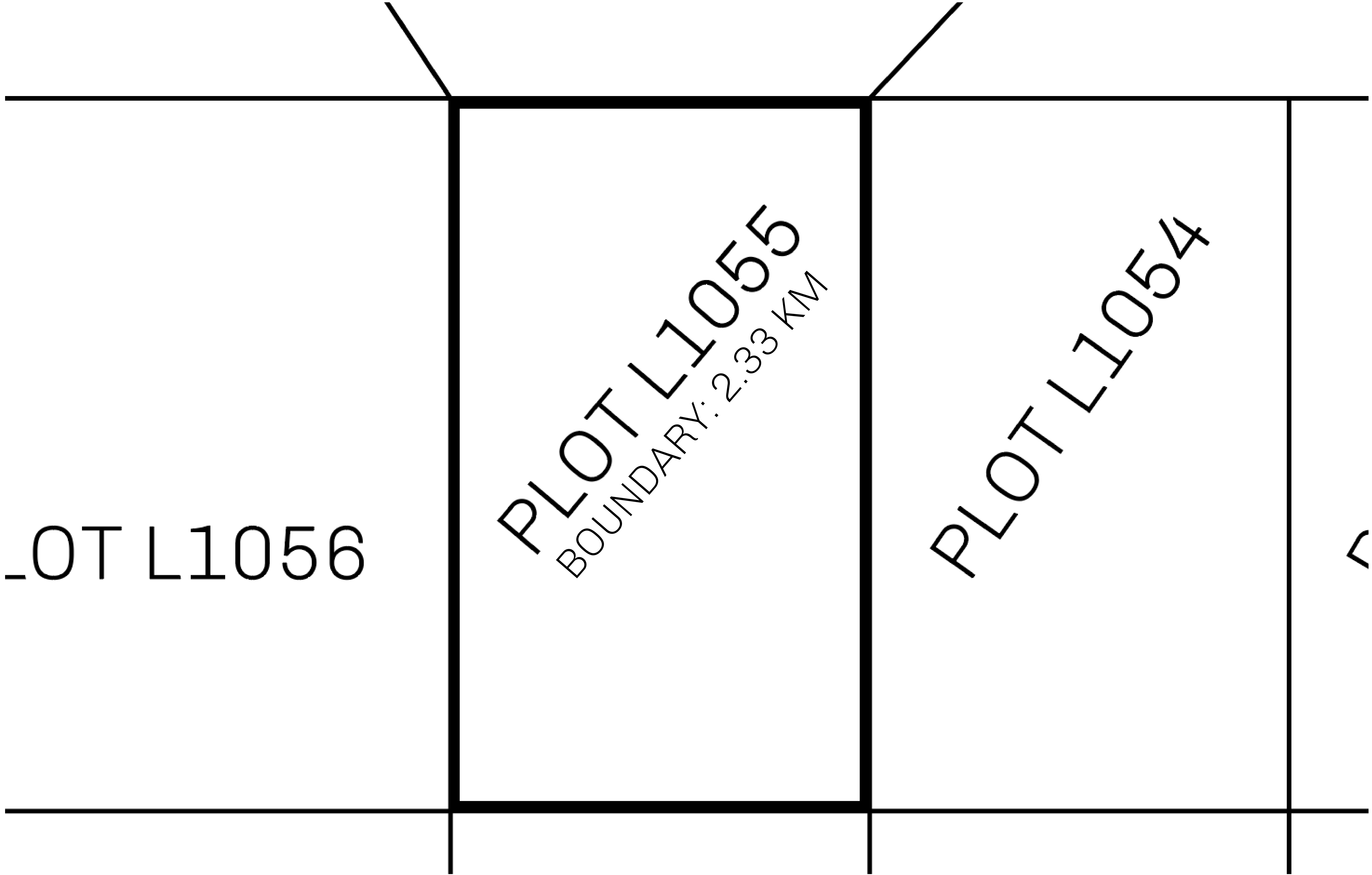

OFFICIAL PERSPECTIVE SHEET FOR FILING
Indicate vantage point for each drawing. Copy and mark each sheet required prior to filing.

Guide - Vantage point should be indicated as shown in the diagram:



Official perspective sheet for filing, featuring a large central rectangular area defined by thick black lines. The sheet is divided into four quadrants by a horizontal line and a vertical line. The top-left and top-right quadrants are further divided by diagonal lines extending from the top corners towards the center. The bottom-left and bottom-right quadrants are also divided by diagonal lines extending from the bottom corners towards the center. The central area is intended for drawing, with a guide indicating the vantage point should be indicated as shown in the diagram.