

LOOT NFT WORLD

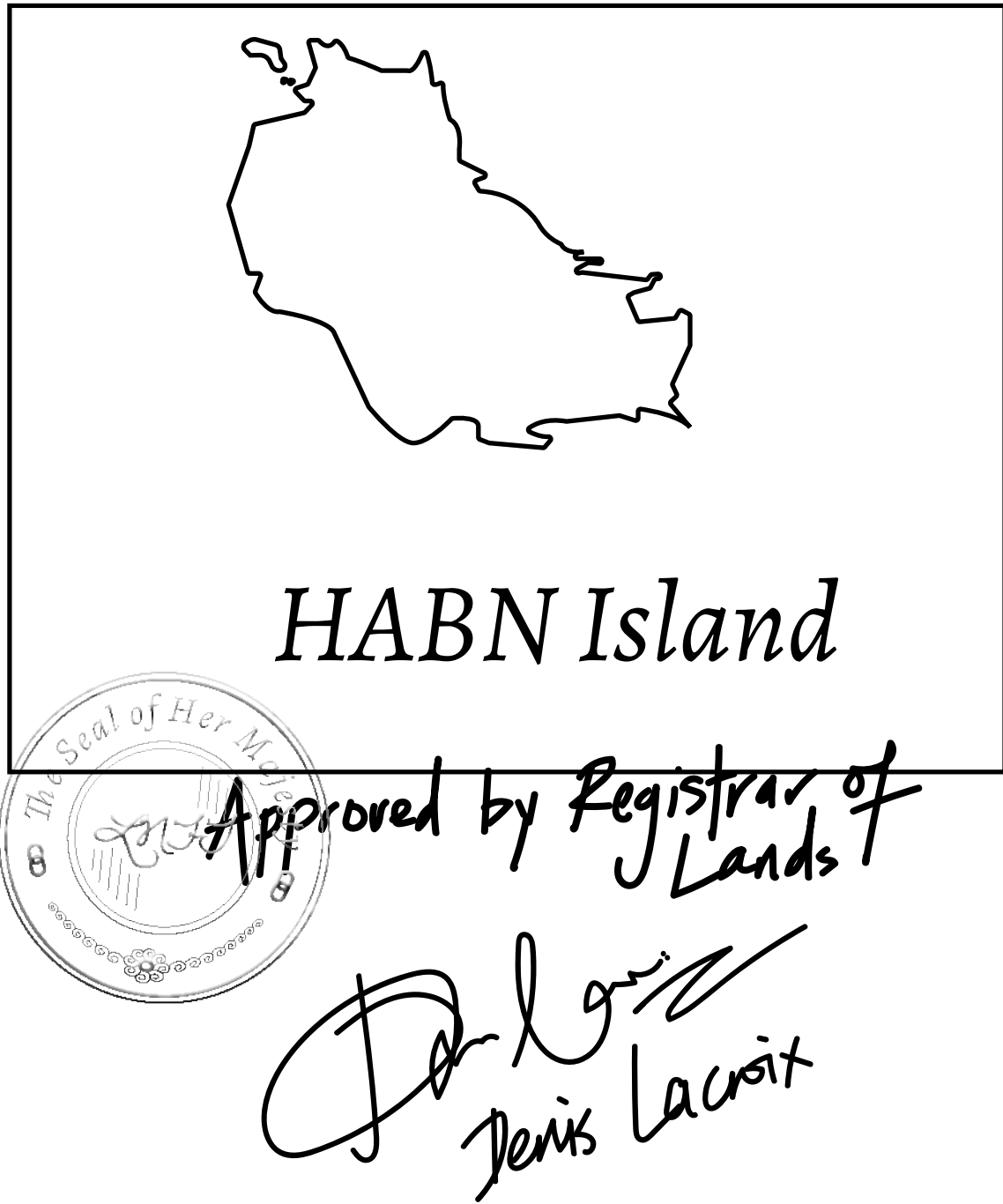

Vault Atoll

*Royaume de
Satoshi*

*Kingdom of
X by SL*

*The Great
Empire*

Isle of Fund

*Territorio
LTT ST*



THE BLOCK PEOPLE

HABN Island is the home of the Block Quarry, the operations center of the sophisticated tools that power financial transactions in the World. BUN, LTT, USDC, USDC platform credits, and NFT transactions and audits are handled on this island.

| GEOGRAPHY | |
|---------------|--------------------------|
| COASTLINE | 63.72 KM (39.59 MILES) |
| BORDERS | OCEAN |
| HIGHEST POINT | MT HEPHAESTUS +2097 M |
| LOWEST POINT | PORT OF BLOCKCHAIN -95 M |
| PLOTS | 181 |
| SCALE | 1:50000 |

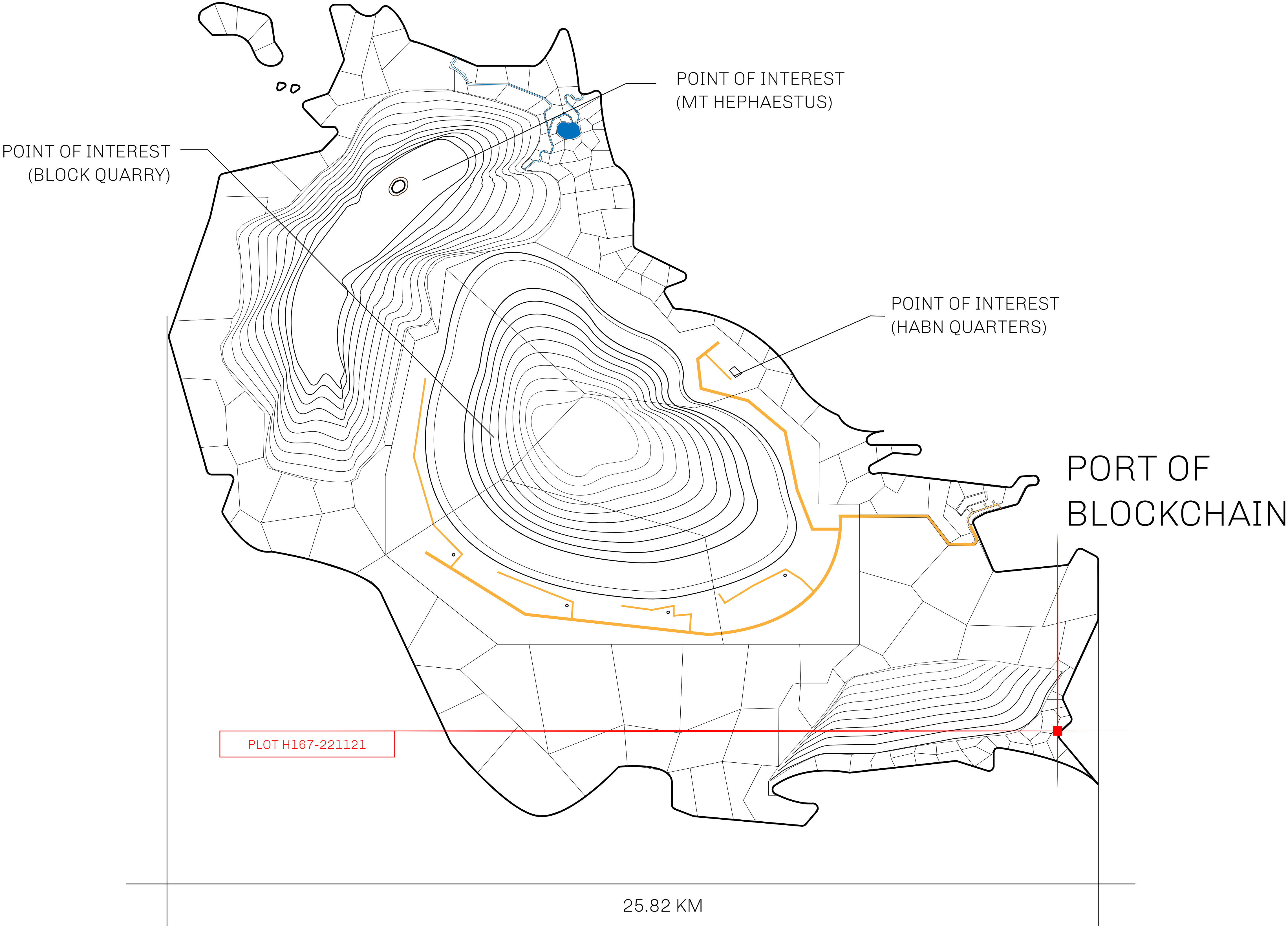



| | | | |
|---------------------------------------|--|---|----------------------|
| <i>H.M. LNFT Land Registry</i> | | TITLE NUMBER | |
| | | H167-221121 | |
| ADMINISTRATIVE AREA | HABN ISLAND | ISSUED 22 November 2021 <i>bi.</i> | SCALE 1/50000 |
| OWNER ENTITLEMENT | Type W-HABN: Mint 4 NFT Stories | | |

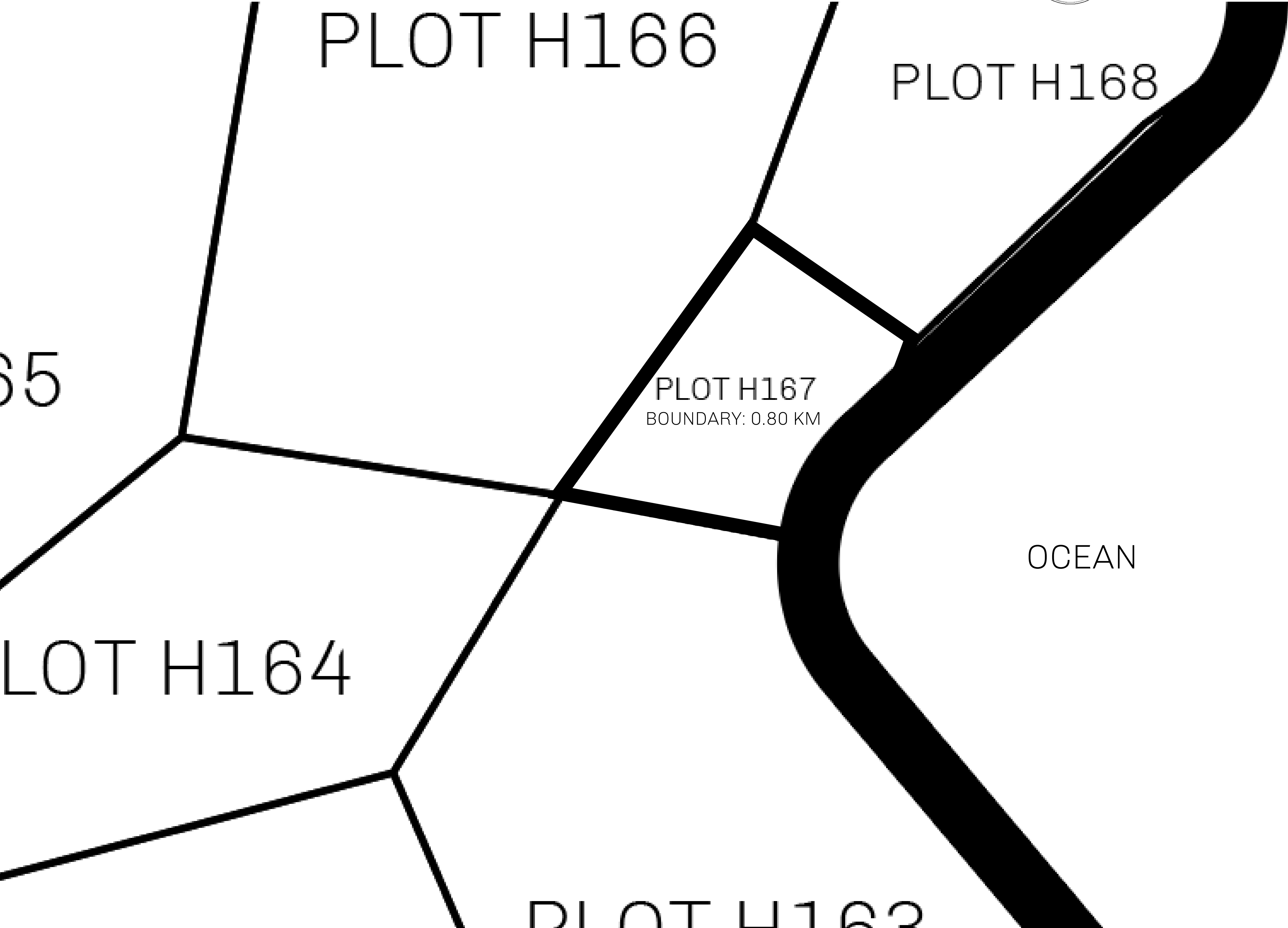

OFFICIAL PERSPECTIVE SHEET FOR FILING
Indicate vantage point for each drawing. Copy and
mark each sheet required prior to filing.

Guide - Vantage point should be
indicated as shown in the diagram:

