

# LOOT NFT WORLD

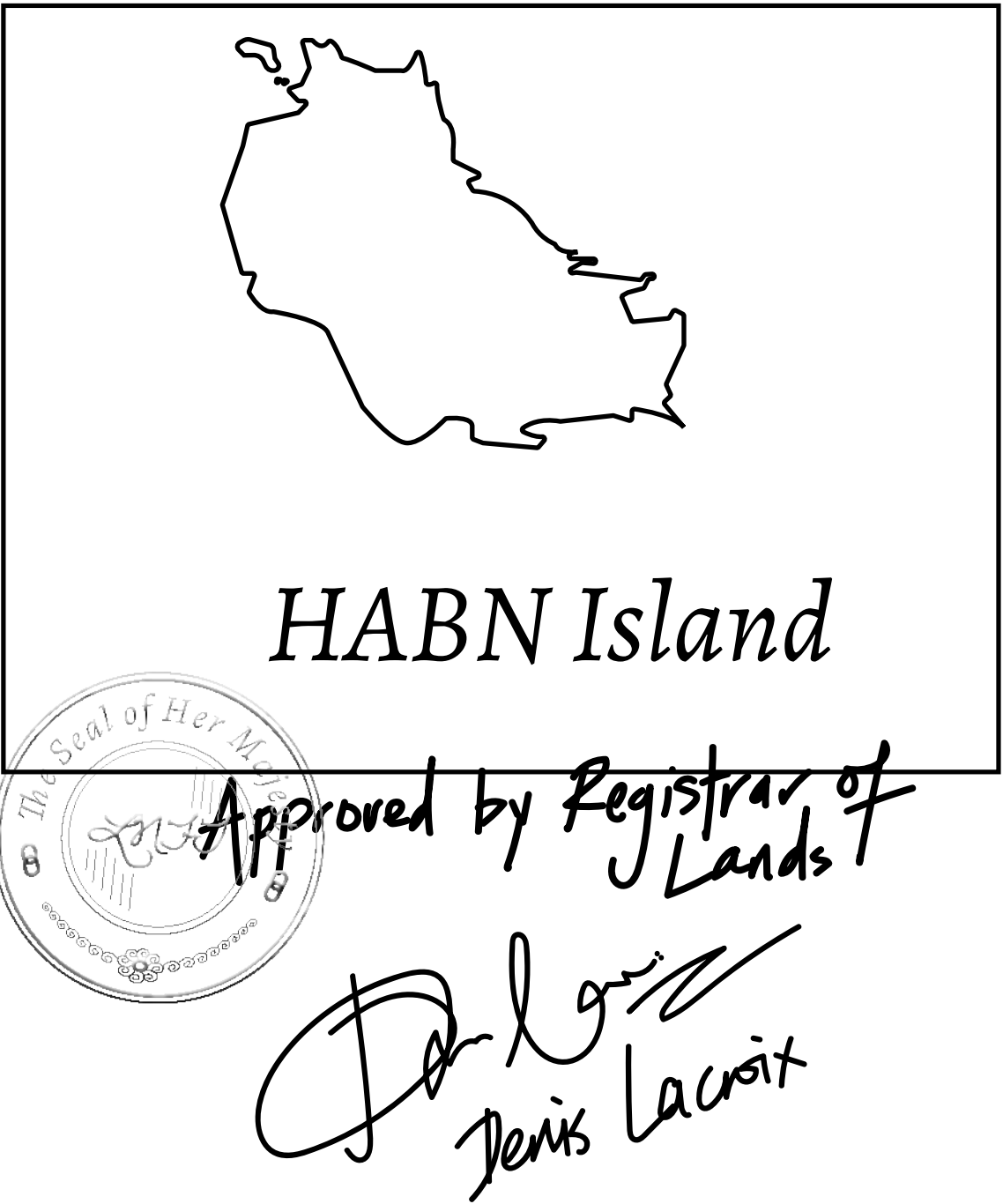

*Vault Atoll*

*Royaume de  
Satoshi*

*Kingdom of  
X by SL*

*The Great  
Empire*

*Isle of Fund*

*Territorio  
LTT ST*



**THE BLOCK PEOPLE**

HABN Island is the home of the Block Quarry, the operations center of the sophisticated tools that power financial transactions in the World. BUN, LTT, USDC, USDC platform credits, and NFT transactions and audits are handled on this island.

GEOGRAPHY	
COASTLINE	63.72 KM (39.59 MILES)
BORDERS	OCEAN
HIGHEST POINT	MT HEPHAESTUS +2097 M
LOWEST POINT	PORT OF BLOCKCHAIN -95 M
PLOTS	181
SCALE	1:50000

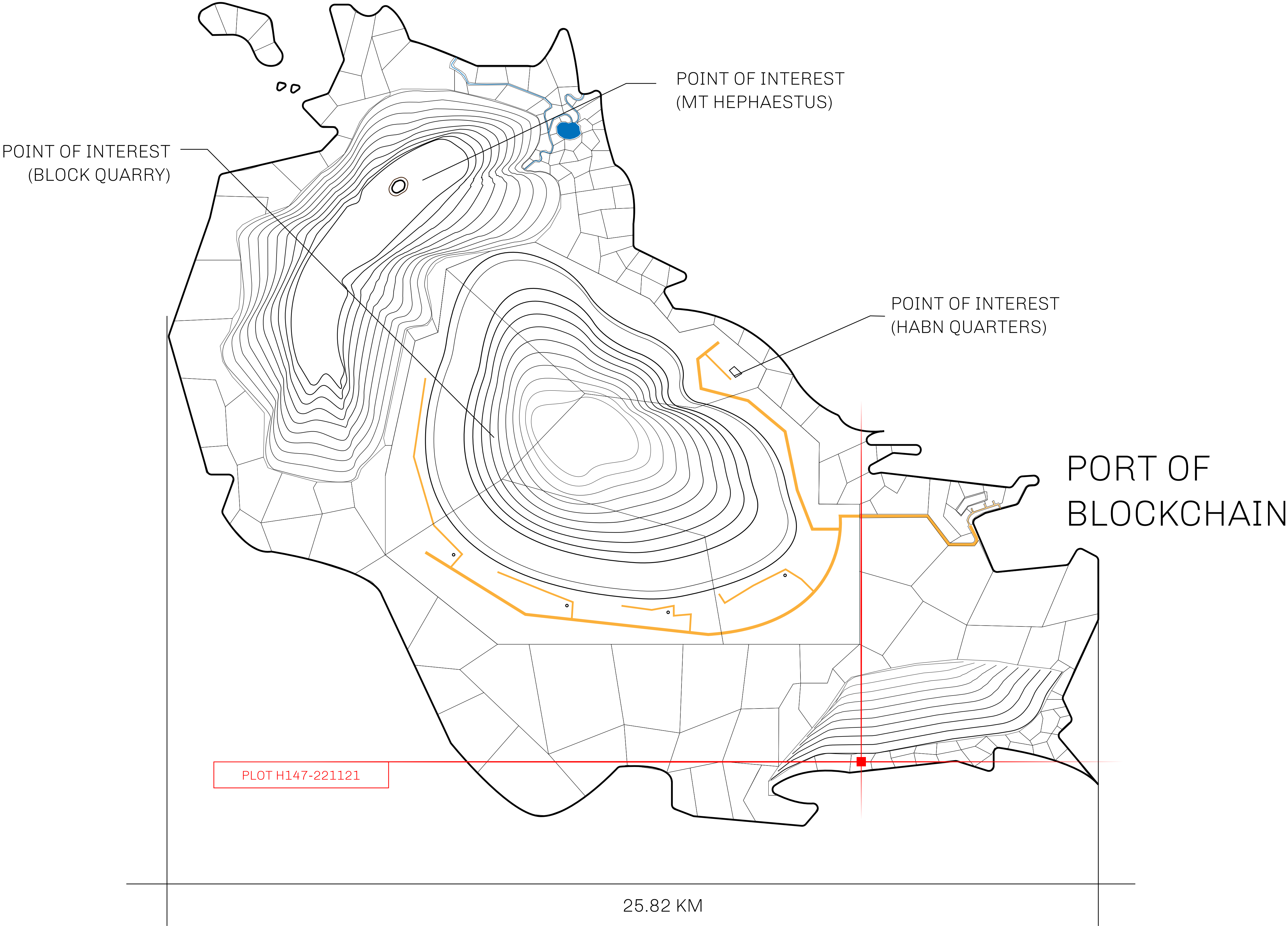





<b>H.M. LNFT Land Registry</b>		TITLE NUMBER	
		<b>H147-221121</b>	
ADMINISTRATIVE AREA	<b>HABN ISLAND</b>	ISSUED <b>22 November 2021</b> <i>bi.</i>	SCALE <b>1/50000</b>
OWNER ENTITLEMENT	<b>Type W-HABN: Mint 4 NFT Stories</b>		



I H126

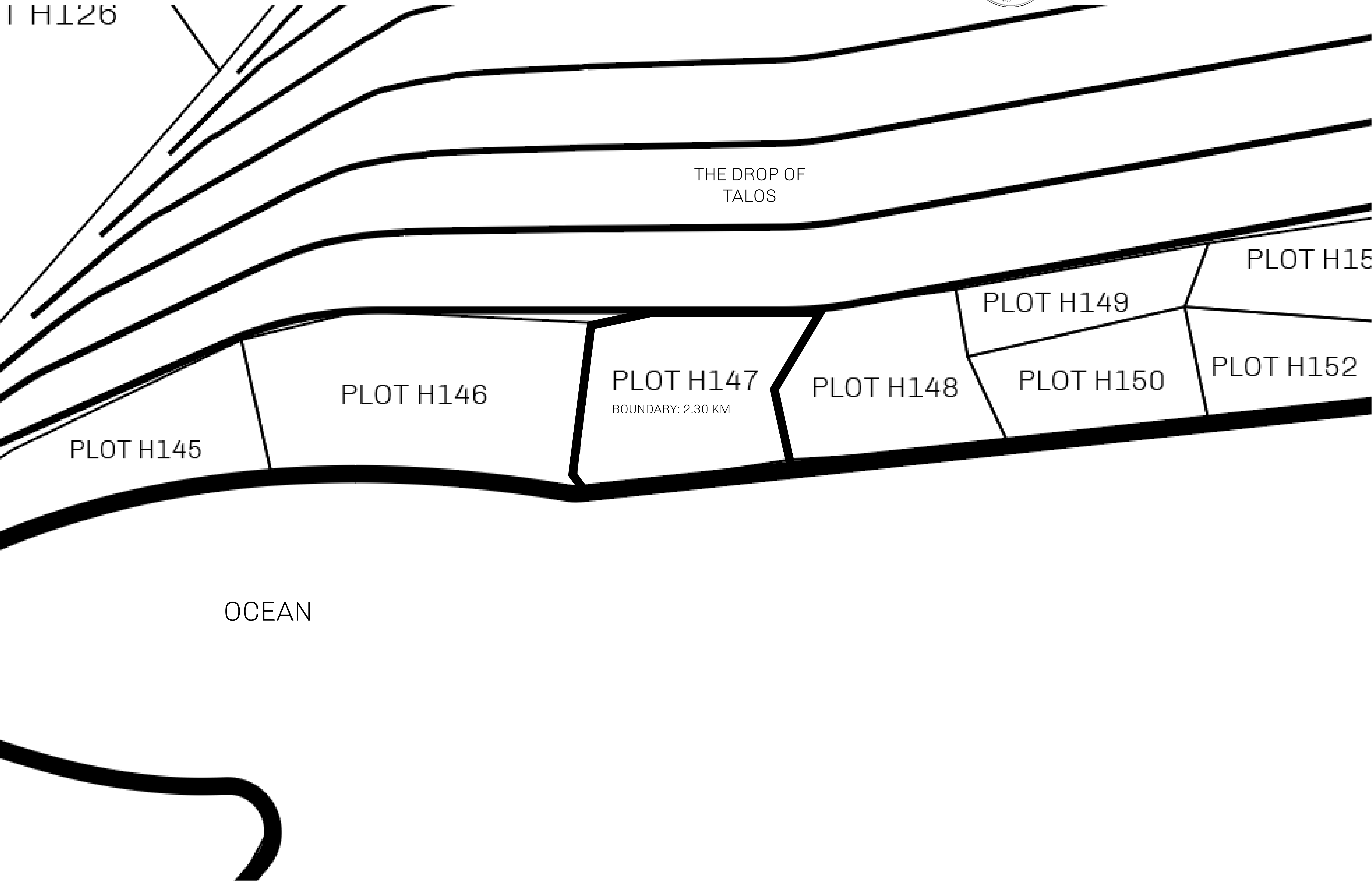

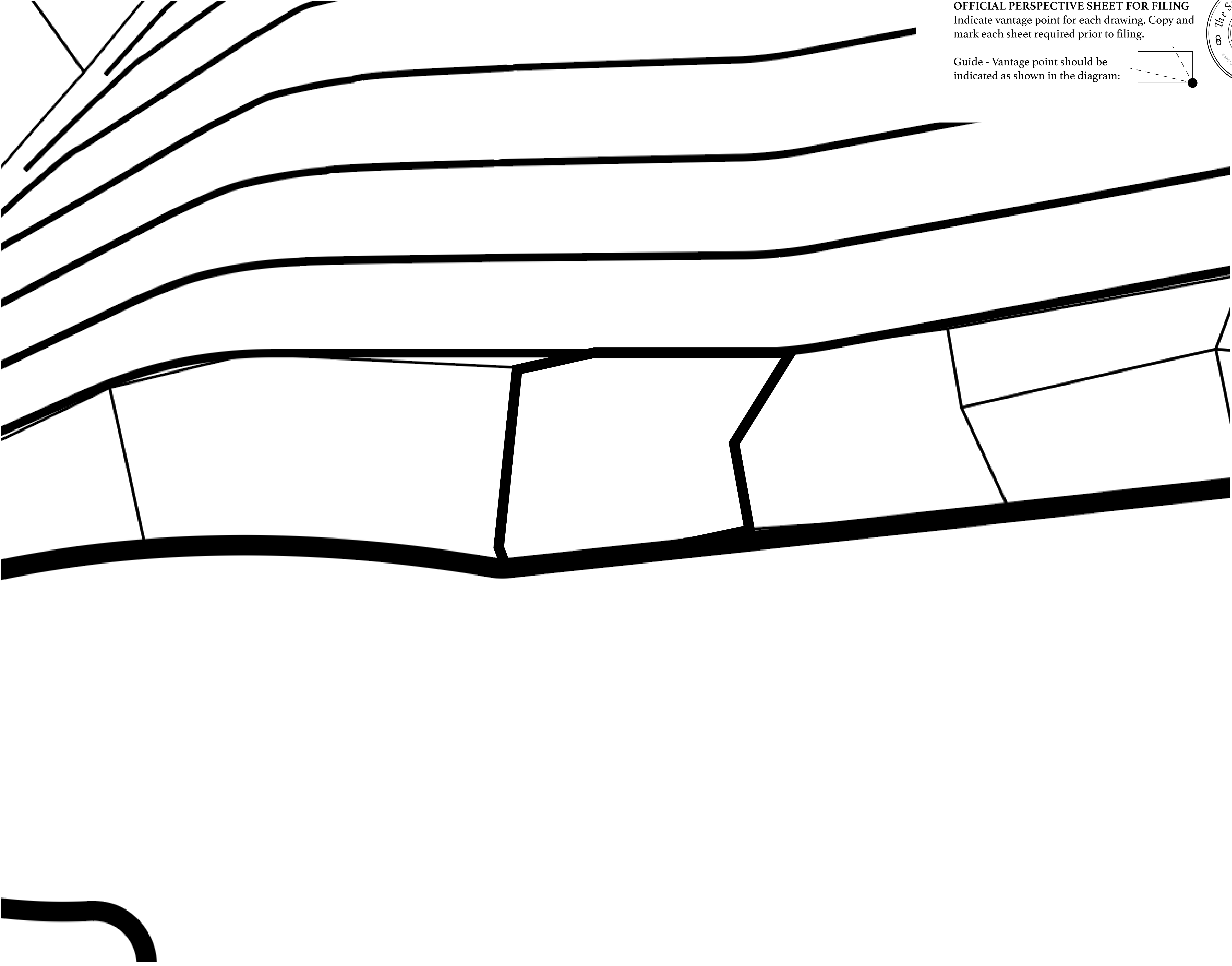

OFFICIAL PERSPECTIVE SHEET FOR FILING  
Indicate vantage point for each drawing. Copy and mark each sheet required prior to filing.

Guide - Vantage point should be indicated as shown in the diagram:

