

LOOT NFT WORLD

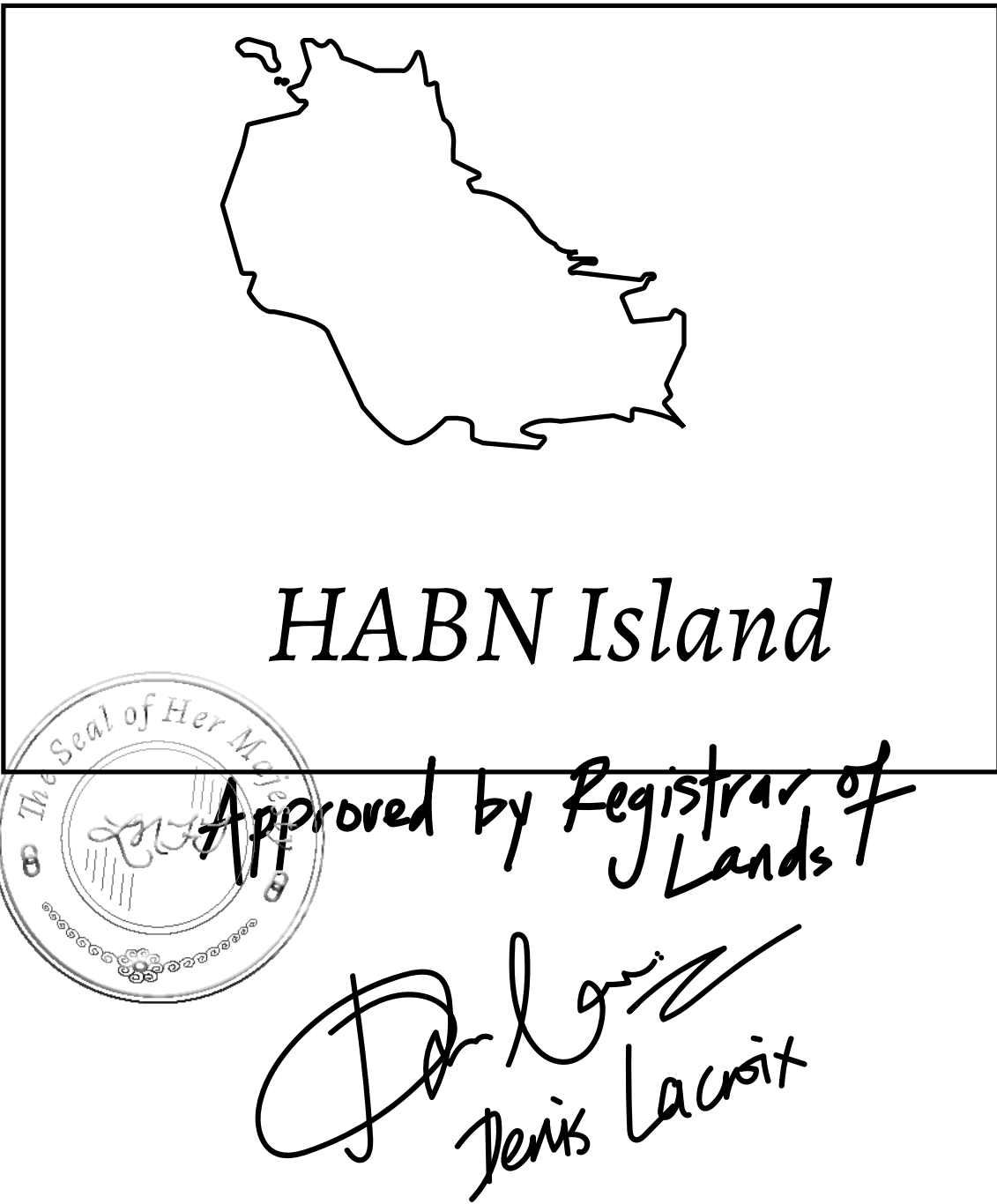
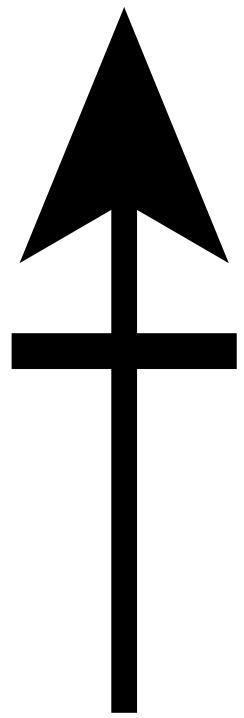

Vault Atoll

*Royaume de
Satoshi*

*Kingdom of
X by SL*

*The Great
Empire*

Isle of Fund

*Territorio
LTT ST*



THE BLOCK PEOPLE

HABN Island is the home of the Block Quarry, the operations center of the sophisticated tools that power financial transactions in the World. BUN, LTT, USDC, USDC platform credits, and NFT transactions and audits are handled on this island.

GEOGRAPHY

COASTLINE	63.72 KM (39.59 MILES)
BORDERS	OCEAN
HIGHEST POINT	MT HEPHAESTUS +2097 M
LOWEST POINT	PORT OF BLOCKCHAIN -95 M
PLOTS	181
SCALE	1:50000

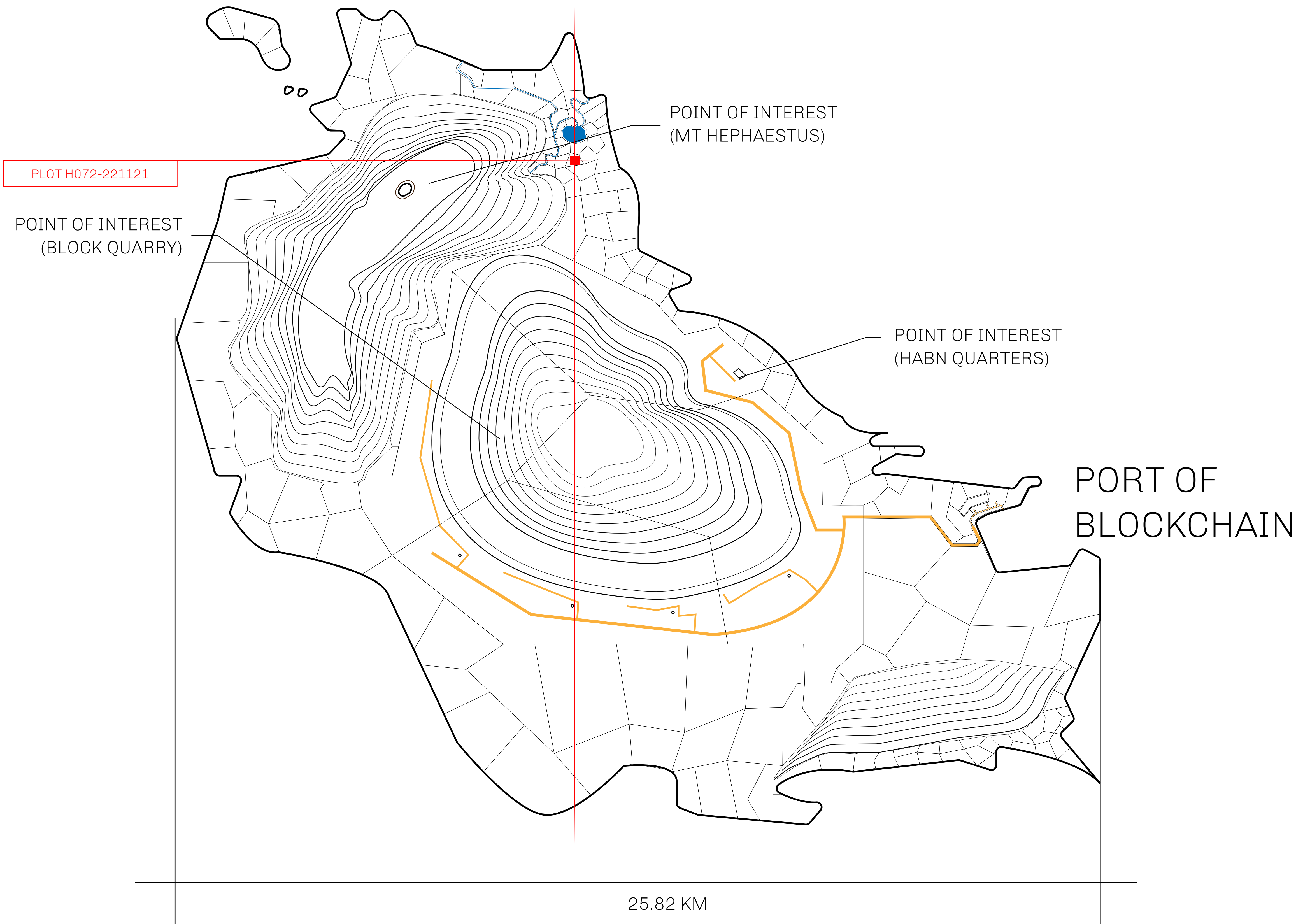
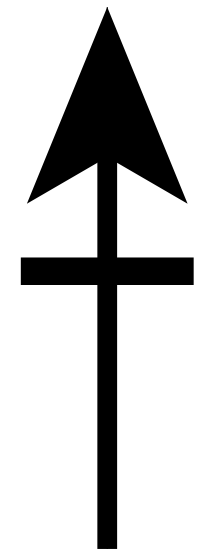



<i>H.M. LNFT Land Registry</i>		TITLE NUMBER	
		H072-221121	
ADMINISTRATIVE AREA	HABN ISLAND	ISSUED 22 November 2021 <i>bi.</i>	SCALE 1/50000
OWNER ENTITLEMENT	Type W-HABN: Mint 4 NFT Stories		

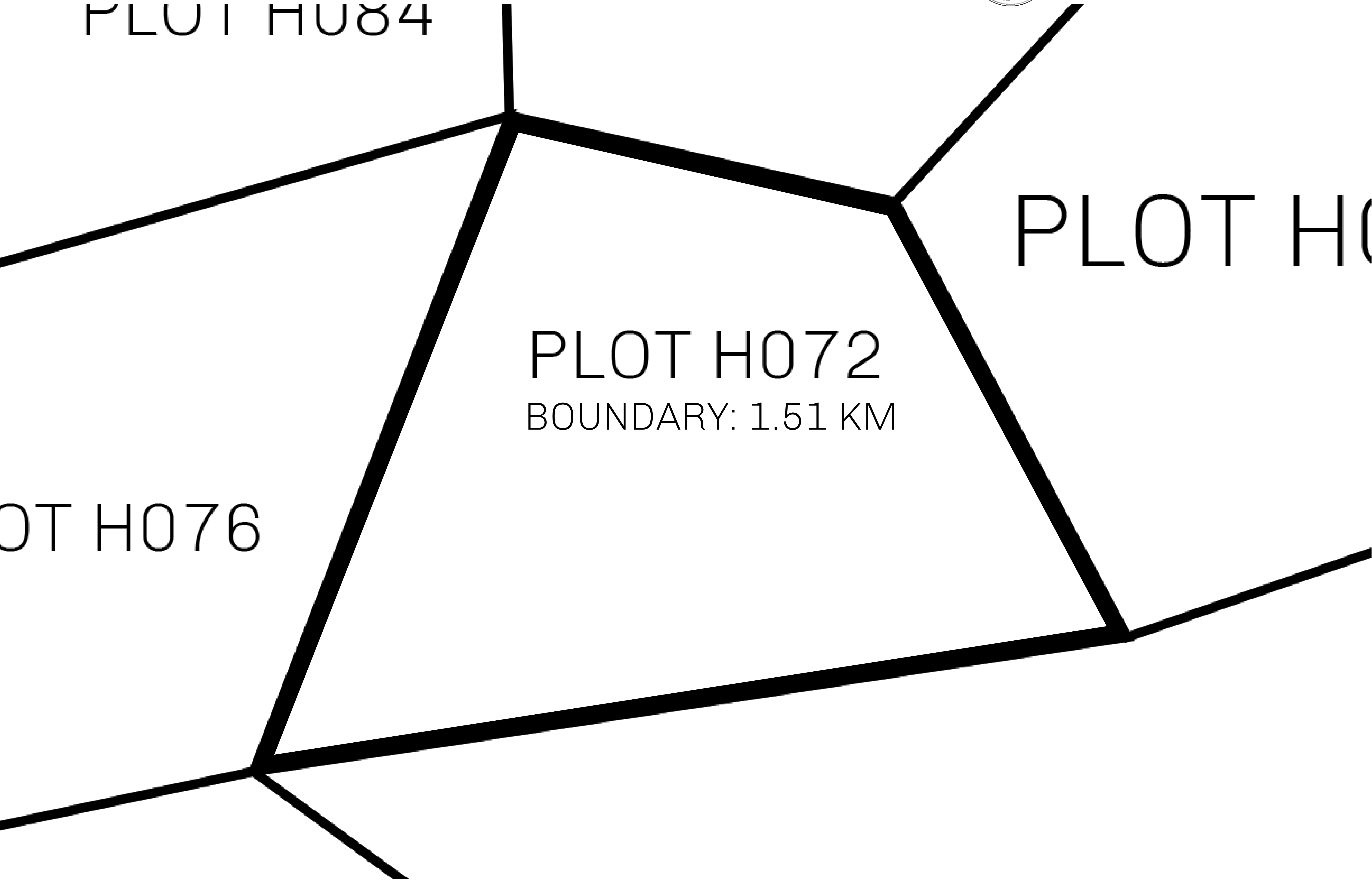

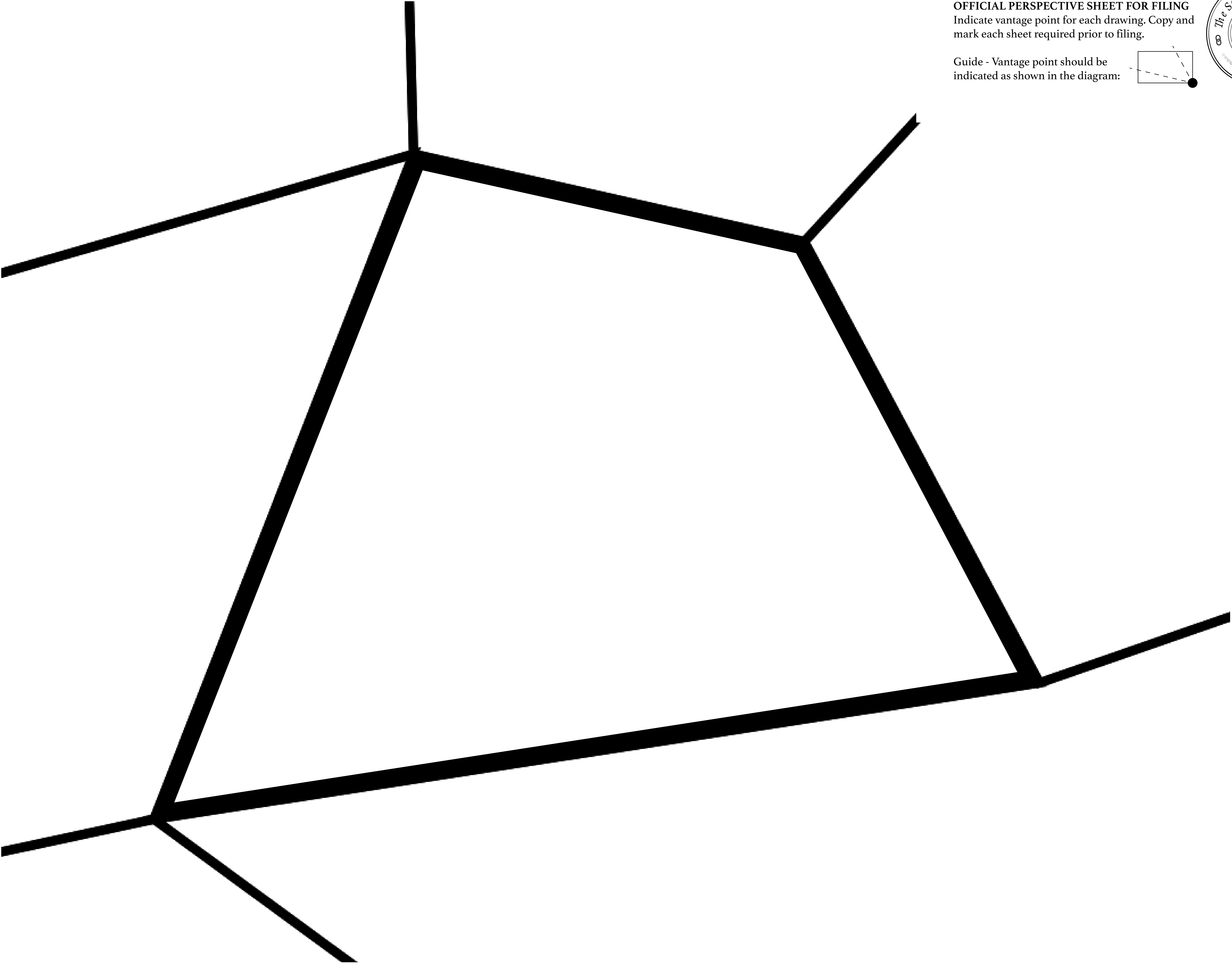

OFFICIAL PERSPECTIVE SHEET FOR FILING
Indicate vantage point for each drawing. Copy and mark each sheet required prior to filing.

Guide - Vantage point should be indicated as shown in the diagram:

